

FOR INDEX OF SHEETS SEE SHEET 1A
THIS PROJECT WAS DEVELOPED UTILIZING THE DEPARTMENT'S ENGINEERING DESIGN PACKAGE (GEOPAK).
GEOPAK Computer Identification No. 108532



COMMONWEALTH OF VIRGINIA
DEPARTMENT OF TRANSPORTATION

PLAN AND PROFILE OF PROPOSED
STATE HIGHWAY

FHWA-534 DATA 23014

STATE	FEDERAL AID	STATE		SHEET NO.
	PROJECT	ROUTE	PROJECT	
VA.	(SEE TABULATION BELOW FOR SECTION NUMBERS)	258	0258 - 300 - 198, PE101, RW201, C501, B601	1

FUNCTIONAL CLASSIFICATION AND TRAFFIC DATA	
URBAN PRINCIPAL ARTERIAL	
	Fr: 0.29 mi East of Jericho Rd. To: 0.71 mi East of Jericho Rd.
ADT	ADT (2016): 12,000 ADT
ADT	ADT (2040): 19,000 ADT
DHV	DHV (2040): 1,880 VPH
D (%) (design hour)	D %: 57
T (%) (design hour)	T %: 1
V (MPH)	V: 40 MPH

R/W PLANS

THESE PLANS ARE UNFINISHED AND UNAPPROVED AND ARE NOT TO BE USED FOR ANY TYPE OF CONSTRUCTION.

From: 0.29 mi East of Jericho Rd.
To: 0.71 mi East of Jericho Rd.

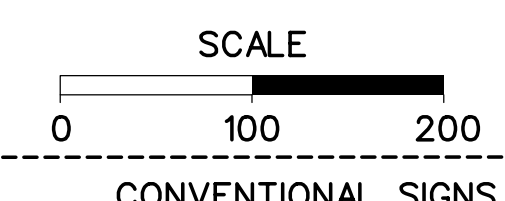
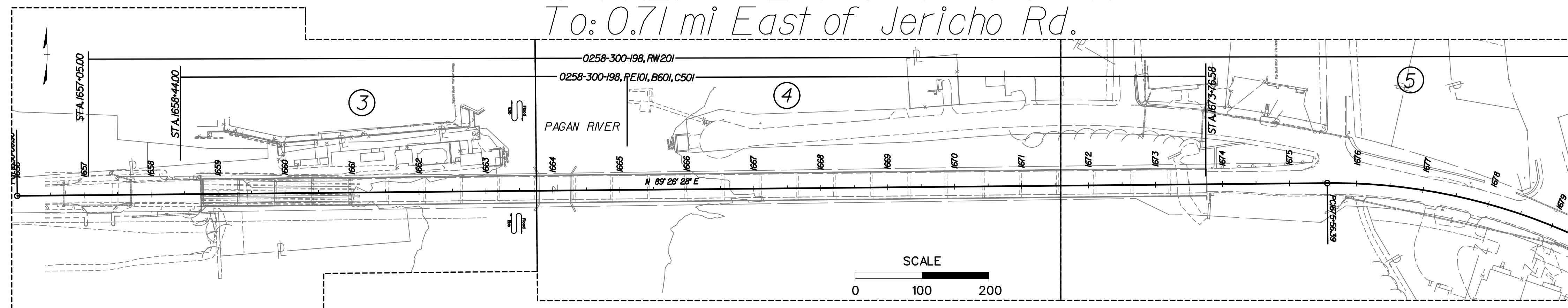

STATE LINE	-----	LEVEE OR EMBANKMENT	-----
COUNTY LINE	-----	BRIDGES	-----
CITY, TOWN OR VILLAGE	-----	CULVERTS	-----
RIGHT OF WAY LINE	-----	DROP INLET	-----
PENCE LINE	-----	POWER POLES	-----
UNFENCED PROPERTY LINE	-----	TELEPHONE OR TELEGRAPH POLES	-----
FENCED PROPERTY LINE	-----	TELEPHONE OR TELEGRAPH LINES	-----
WATER LINE	-----	HEDGE	-----
SANITARY SEWER LINE	-----	TREES	-----
GAS LINE	-----	HEAVY WOODS	-----
ELECTRIC UNDERGROUND CABLE	-----	GROUND ELEVATION	-----
TRAVELED WAY	-----	GRADE ELEVATION	-----
GUARD RAIL	-----		
RETAINING WALL	-----		
RAILROADS	-----		
BASE OR SURVEY LINE	-----		

THE COMPLETE ELECTRONIC PDF VERSION OF THE PLAN ASSEMBLY AS AWARDED, HAS BEEN SEALED AND SIGNED USING DIGITAL SIGNATURES AND THE OFFICIAL PLAN ASSEMBLY IN ELECTRONIC FORMAT IS STORED IN THE VDOT CENTRAL OFFICE PLAN LIBRARY, INCLUDING ALL SUBSEQUENT REVISIONS, WILL BE THE OFFICIAL CONSTRUCTION PLANS. FOR INFORMATION RELATIVE TO ELECTRONIC FILES AND LAYERED PLANS, SEE THE GENERAL NOTES.

DESIGN FEATURES RELATING TO CONSTRUCTION OR TO REGULATION AND CONTROL OF TRAFFIC MAY BE SUBJECT TO CHANGE AS DEEMED NECESSARY BY THE DEPARTMENT.

THIS PROJECT IS TO BE CONSTRUCTED IN ACCORDANCE WITH THE DEPARTMENT'S 2020 ROAD AND BRIDGE SPECIFICATIONS, 2016 ROAD AND BRIDGE STANDARDS, 2009 MUTCD, 2011 VIRGINIA SUPPLEMENT TO THE MUTCD, 2011 VIRGINIA WORK AREA PROTECTION MANUAL REV 1 AND AS AMENDED BY CONTRACT PROVISIONS AND THE COMPLETE ELECTRONIC PDF VERSION OF THE PLAN ASSEMBLY.

ALL CURVES ARE TO BE SUPERELEVATED, TRANSITIONED AND WIDENED IN ACCORDANCE WITH STANDARD TC-5.11, EXCEPT WHERE OTHERWISE NOTED.

THE ORIGINAL APPROVED TITLE SHEET(S), INCLUDING ORIGINAL SIGNATURES, ARE FILED IN THE VDOT CENTRAL OFFICE PLAN LIBRARY. ANY MISUSE OF ELECTRONIC FILES, INCLUDING SCANNED SIGNATURES, IS ILLEGAL AND ENFORCED TO THE FULL EXTENT OF THE LAW.

Population 8,355 (2017 Census)

STATE PROJECT NO.	SECTION	FEDERAL AID PROJECT NO.	TYPE CODE	UPC NO.	EQUALITIES		LENGTH INCLUDING BRIDGE(S)		LENGTH EXCLUDING BRIDGE(S)		BRIDGE PROJECT NO.	TYPE PROJECT	DESCRIPTION
					FEET	MILES	FEET	MILES	FEET	MILES			
0258-300-198	PE-101	STP-5A03(826)	I000	108532	1,531.1	0.290	1,531.1	104.3	0.0120			From: 0.32 mi East of Jericho Rd. To: 0.61 mi East of Jericho Rd.	
	RW-201	STP-BR05(299)	I000	108532	2,243.4	0.425	2,243.4	104.3	0.0120			From: 0.29 mi East of Jericho Rd. To: 0.71 mi East of Jericho Rd.	
	C-501	STP-BR05(300)	I000	108532	1,531.1	0.290	1,531.1	104.3	0.0120			From: 0.32 mi East of Jericho Rd. To: 0.61 mi East of Jericho Rd.	
	B-601	STP-BR05(300)	X081	108532	1,445.8	0.274	1,445.8	104.3	0.0120			From: 0.32 mi East of Jericho Rd. To: 0.61 mi East of Jericho Rd.	

Project Lengths are based on Construction Baseline.

TIER 1 PROJECT

RECOMMENDED FOR APPROVAL FOR RIGHT OF WAY ACQUISITION	
DATE	DISTRICT PLANNING AND INVESTMENT MANAGER
DATE	DISTRICT PROJECT DEVELOPMENT ENGINEER
APPROVED FOR RIGHT OF WAY ACQUISITION	
DATE	DISTRICT ENGINEER/ADMINISTRATOR
RECOMMENDED FOR APPROVAL FOR CONSTRUCTION	
DATE	DISTRICT PLANNING AND INVESTMENT MANAGER
DATE	DISTRICT PROJECT DEVELOPMENT ENGINEER
APPROVED FOR CONSTRUCTION	
DATE	DISTRICT ENGINEER/ADMINISTRATOR

REVISED	

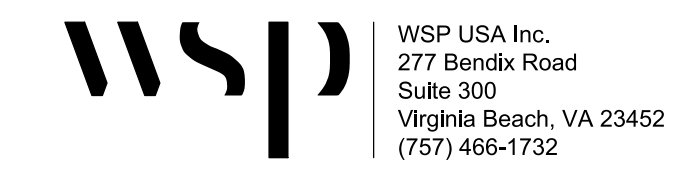

Copyright 2020, Commonwealth of Virginia

PROJECT MANAGER Steve Mao (757) 925-2549 (Hampton Roads District)
SURVEYED BY, DATE H&B, Surveying and Mapping, LLC (804) 330-3781
DESIGN BY WSP, USA, Virginia Beach, VA (757) 466-1732
SUBSURFACE UTILITY BY, DATE Accumark Inc. (757) 277-9998